

STEELWAY

Cellar Doors

STEELWAY CELLAR DOORS
290 E. CHURCH ROAD
KING OF PRUSSIA, PA 19406
TOLL FREE: 877-553-2610
FAX: (610) 277-1440

42" Steel Stair Unit

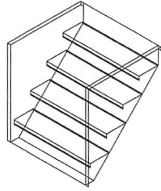

ISOMETRIC VIEW

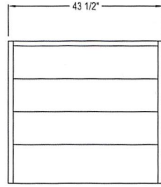

TOP VIEW

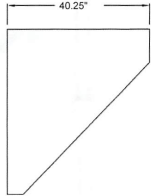

SIDE ELEVATION

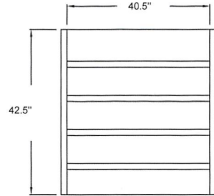

FRONT ELEVATION

SPECIFICATIONS:
MATERIAL: 12 GAUGE HOT ROLLED SHEET METAL
CONNECTIONS: WELDED
COATING: PRIMED RED OXIDE, ASPHALT ON OUTSIDE

- NOTES:
1. INSTALLATION TO BE COMPLETED IN ACCORDANCE WITH MANUFACTURER'S SPECIFICATIONS.
 2. DO NOT SCALE DRAWING.
 3. THIS DRAWING IS INTENDED FOR USE BY ARCHITECTS, ENGINEERS, CONTRACTORS, CONSULTANTS AND DESIGN PROFESSIONALS FOR PLANNING PURPOSES ONLY. THIS DRAWING MAY NOT BE USED FOR CONSTRUCTION.
 4. ALL INFORMATION CONTAINED HEREIN WAS CURRENT AT THE TIME OF DEVELOPMENT BUT MUST BE REVIEWED AND APPROVED BY THE PRODUCT MANUFACTURER TO BE CONSIDERED ACCURATE.
 5. CONTRACTOR'S NOTE: FOR PRODUCT AND COMPANY INFORMATION VISIT www.CADdetails.com/info AND ENTER REFERENCE NUMBER 5312-013

ONE PIECE STEEL CELLAR ENTRANCE
STEELWAY STAIRS - 42" UNIT (SW-42)

5312-013
PROTECTED BY COPYRIGHT ©2019 CADDETAILS.COM LTD. Rev 7-23

REVISION DATE 16/05/2019
CADdetails.com

42" Unit

STEELWAY

Cellar Doors

STEELWAY CELLAR DOORS
290 E. CHURCH ROAD
KING OF PRUSSIA, PA 19406
TOLL FREE: 877-553-2610
FAX: (610) 277-1440

62" Steel Stair Unit

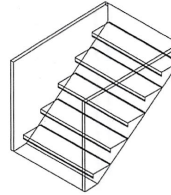

ISOMETRIC VIEW

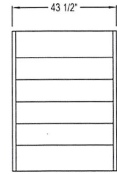

TOP VIEW

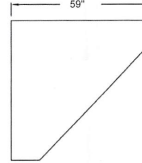

SIDE ELEVATION

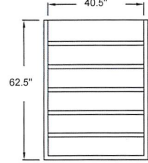

FRONT ELEVATION

SPECIFICATIONS:
MATERIAL: 12 GAUGE HOT ROLLED SHEET METAL
CONNECTIONS: WELDED
COATING: PRIMED RED OXIDE, ASPHALT ON OUTSIDE

- NOTES:
1. INSTALLATION TO BE COMPLETED IN ACCORDANCE WITH MANUFACTURER'S SPECIFICATIONS.
 2. DO NOT SCALE DRAWING.
 3. THIS DRAWING IS INTENDED FOR USE BY ARCHITECTS, ENGINEERS, CONTRACTORS, CONSULTANTS AND DESIGN PROFESSIONALS FOR PLANNING PURPOSES ONLY. THIS DRAWING MAY NOT BE USED FOR CONSTRUCTION.
 4. ALL INFORMATION CONTAINED HEREIN WAS CURRENT AT THE TIME OF DEVELOPMENT BUT MUST BE REVIEWED AND APPROVED BY THE PRODUCT MANUFACTURER TO BE CONSIDERED ACCURATE.
 5. CONTRACTOR'S NOTE: FOR PRODUCT AND COMPANY INFORMATION VISIT www.CADdetails.com/info AND ENTER REFERENCE NUMBER 5312-014

ONE PIECE STEEL CELLAR ENTRANCE
STEELWAY STAIRS - 62" UNIT (SW-42)

5312-014
PROTECTED BY COPYRIGHT ©2019 CADDETAILS.COM LTD. Rev 7-23

REVISION DATE 16/05/2019
CADdetails.com

62" Unit

STEELWAY

Cellar Doors

STEELWAY CELLAR DOORS
290 E. CHURCH ROAD
KING OF PRUSSIA, PA 19406
TOLL FREE: 877-553-2610
FAX: (610) 277-1440

69" Steel Stair Unit

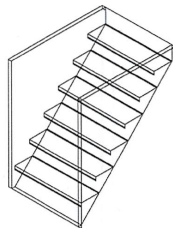

ISOMETRIC VIEW

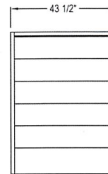

TOP VIEW

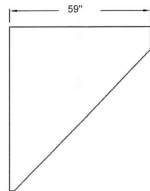

SIDE ELEVATION

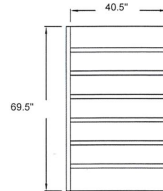

FRONT ELEVATION

SPECIFICATIONS:
MATERIAL: 12 GAUGE HOT ROLLED SHEET METAL
CONNECTIONS: WELDED
COATING: PRIMED RED OXIDE, ASPHALT ON OUTSIDE

- NOTES:
1. INSTALLATION TO BE COMPLETED IN ACCORDANCE WITH MANUFACTURER'S SPECIFICATIONS.
 2. DO NOT SCALE DRAWING.
 3. THIS DRAWING IS INTENDED FOR USE BY ARCHITECTS, ENGINEERS, CONTRACTORS, CONSULTANTS AND DESIGN PROFESSIONALS FOR PLANNING PURPOSES ONLY. THIS DRAWING MAY NOT BE USED FOR CONSTRUCTION.
 4. ALL INFORMATION CONTAINED HEREIN WAS CURRENT AT THE TIME OF DEVELOPMENT BUT MUST BE REVIEWED AND APPROVED BY THE PRODUCT MANUFACTURER TO BE CONSIDERED ACCURATE.
 5. CONTRACTOR'S NOTE: FOR PRODUCT AND COMPANY INFORMATION VISIT www.CADdetails.com/info AND ENTER REFERENCE NUMBER 5312-015

ONE PIECE STEEL CELLAR ENTRANCE
STEELWAY STAIRS - 69" UNIT (SW-69)

5312-015
PROTECTED BY COPYRIGHT ©2019 CADDETAILS.COM LTD. Rev 7-23

REVISION DATE 16/05/2019
CADdetails.com

69" Unit

STEELWAY

Cellar Doors

STEELWAY CELLAR DOORS
290 E. CHURCH ROAD
KING OF PRUSSIA, PA 19406
TOLL FREE: 877-553-2610
FAX: (610) 277-1440

A-Top

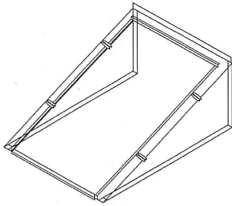

ISOMETRIC VIEW

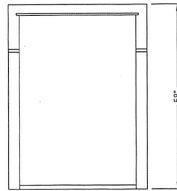

TOP VIEW

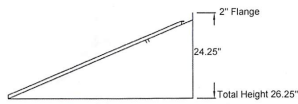

SIDE ELEVATION

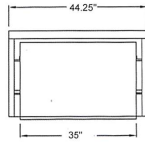

FRONT ELEVATION

SPECIFICATIONS:

MATERIAL: 12 GAUGE HOT ROLLED SHEET METAL
CONNECTIONS: WELDED
COATING: RED OXIDE PRIMER

NOTES:

1. INSTALLATION TO BE COMPLETED IN ACCORDANCE WITH MANUFACTURER'S SPECIFICATIONS.
2. DO NOT SCALE DRAWING.
3. THIS DRAWING IS INTENDED FOR USE BY ARCHITECTS, ENGINEERS, CONTRACTORS, CONSULTANTS AND DESIGN PROFESSIONALS FOR PLANNING PURPOSES ONLY. THIS DRAWING MAY NOT BE USED FOR CONSTRUCTION.
4. ALL INFORMATION CONTAINED HEREIN WAS CURRENT AT THE TIME OF DEVELOPMENT BUT MUST BE REVIEWED AND APPROVED BY THE PRODUCT MANUFACTURER TO BE CONSIDERED ACCURATE.
5. CONTRACTOR'S NOTE: FOR PRODUCT AND COMPANY INFORMATION VISIT www.CADdetails.com/info AND ENTER REFERENCE NUMBER 5312-016

ONE PIECE STEEL CELLAR ENTRANCE
STEELWAY CELLAR DOOR - A-TOP UNIT (SW-AT)

5312-016

PROTECTED BY COPYRIGHT ©2019 CADDETAILS.COM LTD. Rev 7-23

REVISION DATE 16/05/2019

CADdetails.com

A-Top

STEELWAY

Cellar Doors

STEELWAY CELLAR DOORS
290 E. CHURCH ROAD
KING OF PRUSSIA, PA 19406
TOLL FREE: 877-553-2610
FAX: (610) 277-1440

B-Top

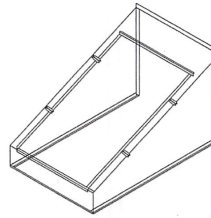

ISOMETRIC VIEW

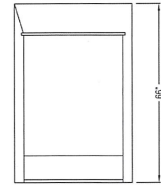

TOP VIEW

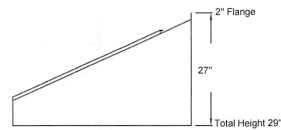

SIDE ELEVATION

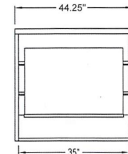

FRONT ELEVATION

SPECIFICATIONS:

MATERIAL: 12 GAUGE HOT ROLLED SHEET METAL
CONNECTIONS: WELDED
COATING: RED OXIDE PRIMER

NOTES:

1. INSTALLATION TO BE COMPLETED IN ACCORDANCE WITH MANUFACTURER'S SPECIFICATIONS.
2. DO NOT SCALE DRAWING.
3. THIS DRAWING IS INTENDED FOR USE BY ARCHITECTS, ENGINEERS, CONTRACTORS, CONSULTANTS AND DESIGN PROFESSIONALS FOR PLANNING PURPOSES ONLY. THIS DRAWING MAY NOT BE USED FOR CONSTRUCTION.
4. ALL INFORMATION CONTAINED HEREIN WAS CURRENT AT THE TIME OF DEVELOPMENT BUT MUST BE REVIEWED AND APPROVED BY THE PRODUCT MANUFACTURER TO BE CONSIDERED ACCURATE.
5. CONTRACTOR'S NOTE: FOR PRODUCT AND COMPANY INFORMATION VISIT www.CADdetails.com/info AND ENTER REFERENCE NUMBER 5312-017

ONE PIECE STEEL CELLAR ENTRANCE
STEELWAY CELLAR DOOR - B-TOP UNIT (SW-BT)

5312-017

PROTECTED BY COPYRIGHT ©2019 CADDETAILS.COM LTD. Rev 7-23

REVISION DATE 16/05/2019

CADdetails.com

B-Top